

Screws for concrete MMS-plus

type Multi-Monti®-plus (with hexagonal head and with panhead), galvanised

Application

- For anchorages free of expansion pressure in cracked and non-cracked concrete
- Direct mounting of attachment parts, such as brackets, support channels, base plates, etc.
- Also applicable in lime sand brick, solid brick, clinker and natural stone
- For anchorages in prestressed concrete hollow core slab ceilings

Your advantages

- More than 25 % reduction of assembly time per attachment point
- Versatile use in concrete and other solid building materials
- High security, no splaying effect - thus can be placed close to the edge and to other screws
- High load capacity due to form lock
- Easy to withdraw, facilitates corrections during installation
- No additional mounting or setting tools required
- European Technical Assessment for cracked and uncracked concrete
- Fire protection in concrete
- Suitable for the installation of gas mains according to the TRGI (Technical Rules for Gas Installations)
- Two effective anchorage depths for greater flexibility
- European Technical Assessment for anchorages in prestressed concrete hollow core slab ceilings
- European Technical Assessment for anchorages in masonry

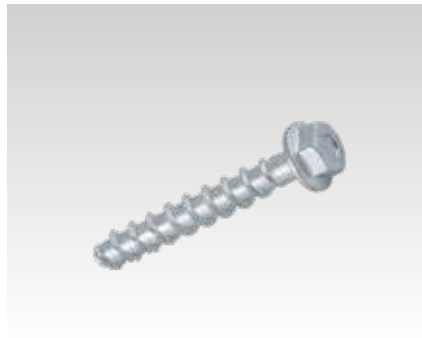

Screw for concrete with hexagonal head and pressed washer type SS

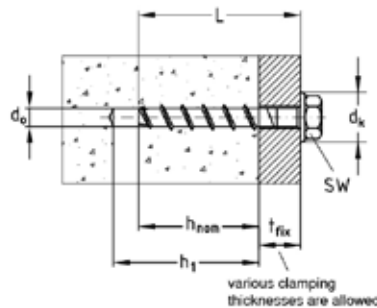

Screw for concrete with panhead (small) type P



Screw for concrete with panhead (large) type MS

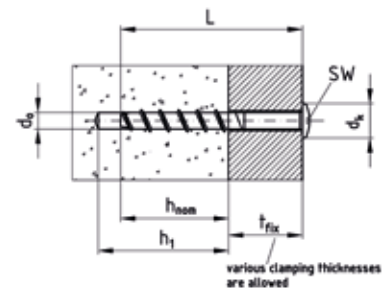

Features



Standard anchorage depth

| Type | Thread diameter [mm] | Length L [mm] | Spanner width SW [mm] | Clamping thickness t _{fix} [mm] | Head diameter dk [mm] | Drilling diameter d ₀ [mm] | Drilling depth h ₁ [mm] | Anchoring depth h _{nom} [mm] | Admissible tensile load cracked concrete C20/25 ¹⁾ [kN] | Admissible tensile load uncracked concrete C20/25 ¹⁾ [kN] | Part no. | Sales unit | Pack unit |
|--|----------------------|---------------|-----------------------|--|-----------------------|---------------------------------------|------------------------------------|---------------------------------------|--|--|----------|------------|-----------|
| With hexagonal head and pressed washer type SS | 7.5 | 40 | 10 | 5 | 14 | 6 | 40 | 35 | 1 | 2 | 166632 | 100 | Pieces |
| | | 50 | | 15 | | | | | | | 166633 | | |
| | | 60 | | 5 | | | 166634 | | | | | | |
| | 10 | 70 | 13 | 5 | 19 | 8 | 75 | 65 | 4.4 | 7.9 | 166635 | 25 | |
| | | 100 | | 45 | | | | | | | 166636 | | |
| | | 120 | | 55 | | | | | | | 166637 | | |
| With panhead (small) type P | 7.5 | 90 | TX30 | 1 | 22 | 10 | 100 | 90 | 7.9 | 12.3 | 166638 | 100 | |
| | | 40 | | 5 | | | | | | | 166646 | | |
| | | 50 | | 15 | | | | | | | 166647 | | |
| With panhead (large) type MS | 7.5 | 60 | TX30 | 5 | 17 | 10 | 65 | 55 | 2 | 4.4 | 166648 | 50 | |
| | | 40 | | 40 | | | | | | | 35 | | |
| | | 50 | | 15 | | | 166641 | | | | | | |

Screws for concrete MMS-plus type Multi-Monti®-plus (with hexagonal head and with panhead), galvanised

| Reduced anchorage depth | | | | | | | | | | | | | | |
|--|-----------------------------|---------------|-----------------------|-----------------------------------|--------------------------|------------------------------|---------------------------|--------------------------------|--|--|----------|------------|-----------|--|
| Type | Thread diameter [mm] | Length L [mm] | Spanner width SW [mm] | Clamping thickness t_{fix} [mm] | Head diameter d_k [mm] | Drilling diameter d_o [mm] | Drilling depth h_1 [mm] | Anchoring depth h_{nom} [mm] | Admissible tensile load cracked concrete C20/25 ¹⁾ [kN] | Admissible tensile load uncracked concrete C20/25 ¹⁾ [kN] | Part no. | Sales unit | Pack unit | |
| With hexagonal head and pressed washer type SS | 7.5 | 60 | 10 | 25 | 14 | 6 | 40 | 35 | 1 | 2 | 166634 | 50 | Pieces | |
| | | 80 | | 45 | | | | | | | 166635 | | | |
| | | 100 | | 65 | | | | | | | 166636 | | | |
| | 10 | 70 | 13 | 20 | 19 | 8 | 60 | 50 | 3 | 5.9 | 166637 | 25 | | |
| | | 100 | | 50 | | | | | | | 166638 | | | |
| | | 120 | | 70 | | | | | | | 166639 | | | |
| | 12 | 90 | 15 | 15 | 22 | 10 | 85 | 75 | 5.9 | 9.9 | 172692 | | | |
| | With panhead (small) type P | 7.5 | 60 | TX30 | 25 | 14 | 6 | 40 | 35 | 1 | 2 | 166648 | 50 | |

¹⁾ The admissible loads apply for single anchors, concrete strength class \geq C20/25 (B25), for central load without influence of axial spacing and edge spacing in cracked and uncracked concrete. The European Technical Assessment ETA-15/0784 shall be observed for dimensioning.

-  For further installation parameters and loads for use in areas with requirements on the duration of fire resistance, please refer to the „Technical information“ chapter.
- Installation data for anchoring in prestressed concrete hollow chamber ceilings and masonry see chapter „Technical information“.
- For fitting tools please refer to chapter „Tools“.

